



## PVC WALL AND CEILING PANELS

### SUITABLE FOR:

- Car/Truck Wash
- Food Preparation
- Agriculture Applications



#### Standard Lengths:

200 / 250 / 300 / 350 / 400 / 450 / 500 mm

BOLEX Group s.r.o.

+421 905 755 895   info@bolex-systems.eu

**www.bolex-systems.eu**

# COLOR CHART

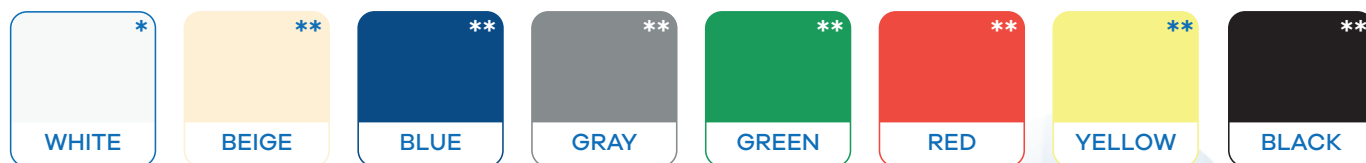

\* white color on stock / \*\* the other colors on order

## ACCESSORIES

Standard Lengths 300 mm and 400 mm



J Trim (ET-JT)

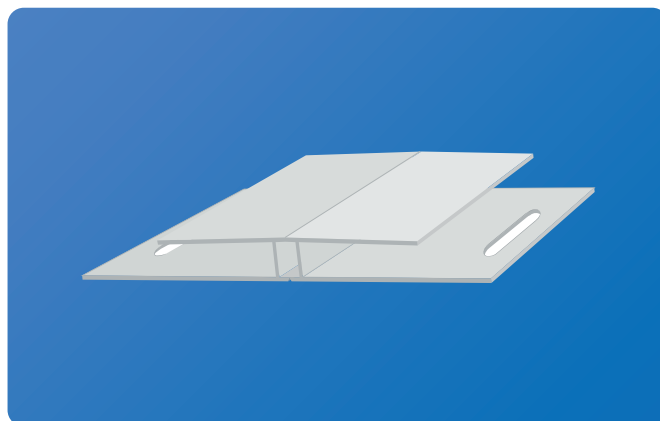

MULTI H Trim (ET-MH)



Drip Trim (ET-DT)



MULTI CORNER  
Trim (ET-MC)



90 Trim (ET-90)



CROWN BASE  
(ET-CB)



CROWN CAP  
(ET-CC)

BOLEX Group s.r.o.

+421 905 755 895   info@bolex-systems.eu

**www.bolex-systems.eu**

# Installation Guide

**This Installation Guide is suitable for 300, 400, 450 mm widths**



## Trims

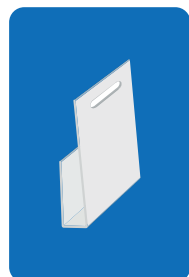

J Trim  
(ET-JT)



MULTI H Trim  
(ET-MH)



Drip Trim  
(ET-DT)

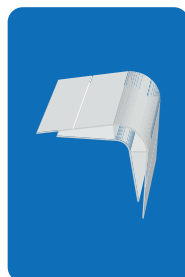

MULTI CORNER  
Trim (ET-MC)

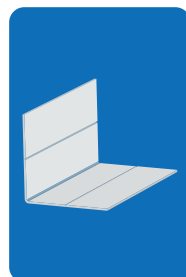

90 Trim  
(ET-90)

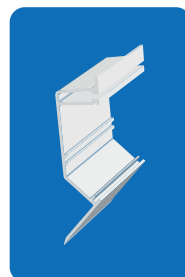

CROWN BASE  
(ET-CB)



CROWN CAP  
(ET-CC)

## Accessories

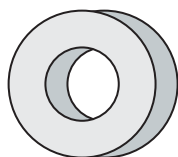

Plastic Spacer  
OD 25 mm x ID 13 mm x Thick 9 mm



Tapcon Screws  
4,7 x 31,25 mm Hex Head



Stainless Screw  
4,2 x 31,25 mm Phillips Truss Head

BOLEX Group s.r.o.

+421 905 755 895   info@bolex-systems.eu

**www.bolex-systems.eu**

# Trims Variation

## MULTI CORNER Trim (ET-MC)

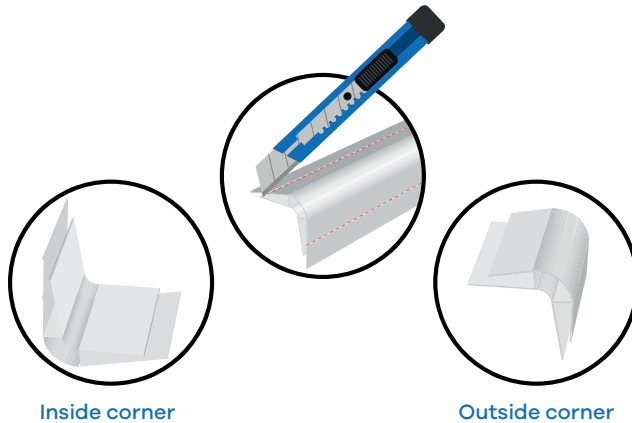

## MULTI H Trim (ET-MH)

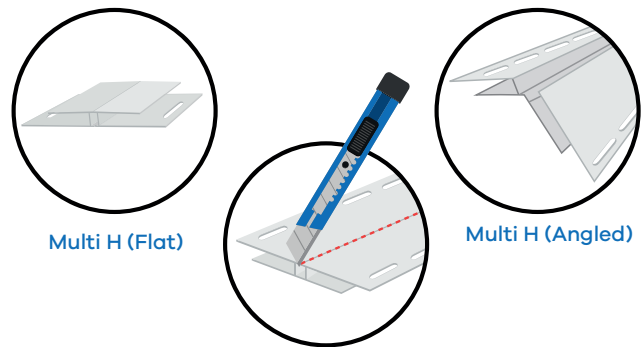

## PLEASE READ THIS ENTIRE GUIDE PRIOR TO INSTALLATION AS THERE ARE DIFFERENT INSTALLATION METHODS FOR WALLS ONLY VS WALLS AND CEILINGS.

- IMPROPER STORAGE WILL VOID ANY WARRANTY DUE TO DAMAGE BY DIRECT SUNLIGHT OR NOT BEING ABLE TO BREATHE IN A CONFINED LOCATION.
- IF THE PRODUCT HAS BEEN PACKAGED AND SHIPPED ON A SKID, CUT ALL STRAPS AND LOOSEN ANY 2 X 4 SO THE MATERIAL IS NOT RESTRICTED FROM EXPANSION IN A CONFINED ENVIRONMENT.
- ALL MATERIAL SHOULD BE CLIMATIZED FOR 24 HOURS IN THE INSTALLATION LOCATION TO A MINIMUM OF 5 DEGREES CELCIUS PRIOR TO INSTALLATION.
- ALL RADIANT HEAT MUST BE AT A MINIMUM 450 mm CLEARANCE FROM SURFACE THE PRODUCT.
- PROVIDE A CLEARANCE AT EITHER END HORIZONTALLY OF 6 mm FOR THE CEILING. PROVIDE A CLEARANCE OF 12 mm VERTICALLY AT THE TOP OF THE WALL.

## Recommended Tools List

- Ladders/Scaffolding
- Rubber Mallet
- Rotary Hammer Drill
- Drill c/w Hole Saws
- Caulking Gun
- Circular Saw with Fine Tooth Blade
- Tape Measure
- Box Cutter
- Battery Drill
- Square & Straight Edge
- Chalk Line

BOLEX Group s.r.o.

+421 905 755 895   info@bolex-systems.eu

**www.bolex-systems.eu**

# WALL ONLY Installation

## 1.

Wet vs Controlled (non-wet) environment:

- Wet environment. Install the MULTI CORNER (ET-MC) for the inside corners first. Take the trim to the top of the wall and 25 mm up off the floor. Go to Step #2.
- Controlled environment. Install the MULTI CORNER (ET-MC) for the inside corners first. Take the trim to the top of the wall and to the floor for controlled environment then go to Step #3.

## 2.

If walls are being installed in a wet environment such as a car wash, the bottom J Trim (ET-JT) needs to be the next. You must drill a 6 mm hole in the bottom of the J Trim at 400 mm centers for water drainage when the walls are washed with a power washer (Pictures A & B). For installation, run a chalk line all around the bottom of the floor about 25 mm off the floor or use our plastic spacers to the necessary gap off the floor (Picture C).



Picture A

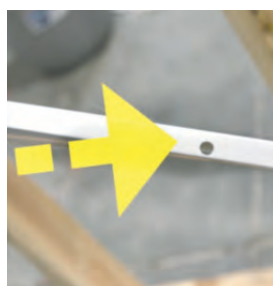

Picture B



Picture C

## 3.

If the walls are installed in a controlled environment (non-wet), then the J Trim can be installed directly to the floor and no drain holes are required.

## 4.

Install the J Trim all around the top of the wall at whatever height the wall will be installed. Cut back the face of the J Trim the same as the bottom J Trim at each corner (Pictures D & E).

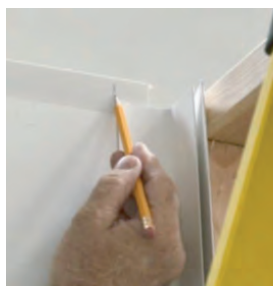

Picture D



Picture E

### **\*\*Account for expansion with J Trim\*\***

If the wall is not going to the ceiling, then install the J Trim (12 mm) above the height of the panel for expansion of the panel in the J Trim. If it is going to the ceiling, then make sure the panel is cut (12 mm) smaller than the opening size for future expansion.

BOLEX Group s.r.o.

+421 905 755 895   info@bolex-systems.eu

**www.bolex-systems.eu**

## 5.

Do a physical layout as it may be beneficial to have a panel seam at an obstruction or pipe penetration. If not, then measure the total distance and deduct the width of the panels (determine whether you have a 300 mm, 400 mm or 450 mm panel) being used so that you do not end up with a small sliver of a panel at one end.

## 6.

If you need to cut the first panel after you pre-measure, then start with this cut panel in the corner with the cut end going inside the MULTI CORNER (ET-MC) and in the bottom track of the J Trim. Use a level to vertically plumb the first or second panel (Picture F). You will need to "bow" the panel slightly to get it into the top J Trim as well (Picture G). Carry on installing the balance of the panels with a 600 mm centerline between screws and the top and bottom screw starting at 300 mm (Picture H).



Picture F



Picture G

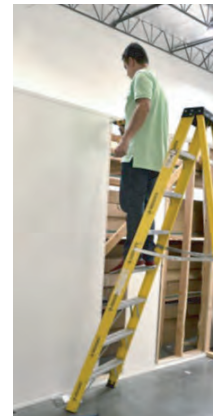

Picture H

## 7.

If installing in a concrete or block wall, predrill with the Rotary Hammer Drill then screw the Tapcon screws with the battery drill. If going into another surface, please ensure you have the correct screw in stainless steel for the substructure.

**\*\*Account for expansion when installing in cold temperatures\*\***

Ensure that you open the gap between each panel with a putty knife to allow for expansion in hotter temperatures.

## 8.

The last panel must be inserted into the slot of the MULTI CORNER (ET-MC) with a sheetrock putty knife. This will need 6 mm clearance for expansion so ensure the last panel is cut 6 mm less than the opening width.

## 9.

If you are mounting a heavy object to the wall such as an electrical box then you should use the plastic spacers to prevent the panel from being crushed if the screws are tightened too tight. The spacer is just a little thicker than the panel. Drill a hole (25 mm) in diameter and fit the spacer in the hole. The inner hole can now receive any bolt or screw up to 12 mm in diameter and will leave the object just short of hitting the panel.

# WALLS AND CEILING Installation

If the project is requiring installation of walls and ceilings, then there are several items that need to be determined first:

a) Is it a wet environment?

- I. If so the J Trim needs to be installed per Step #2 on WALL ONLY Installation.
- II. If not, then J Trim needs to be installed per Step #3 on WALL ONLY Installation.

b) Is it a food safe environment?

- I. If so, then you need to use the MULTI CORNER (ET-MC) for the wall to ceiling transition.
- II. If not, then the assumption will be a 2-piece CROWN Trim (ET-CB and ET-CC) for the wall to ceiling transition.

BOLEX Group s.r.o.

+421 905 755 895   info@bolex-systems.eu

**www.bolex-systems.eu**



## 1.

**Method for Food Safe.** If the MULTI CORNER (ET-MC) is used, then it must be installed first around the perimeter of the wall to ceiling joint. It would not matter after this installation if the wall or ceiling was installed next. If the wall is installed next, then go to the WALL ONLY Installation and start from Item #3 for the J Trim on the ground.

## 2.

When the ceiling is installed you will first need to determine the direction of the ceiling panels.

- I. If the panels are running the length of the room and perpendicular to the trusses, then you **MUST** make sure that you received MULTI H Trims (ET-MH) to join the lengths together.
- II. If both the panels and joists are running the width of the room, then a sub-frame needs to be installed at 600 mm centers. Once the sub frame is completed, then proceed to install the ceiling panels as in Item 3 (Picture I).



Picture I

## 3.

Start at one end and clip the end of the panel into the MULTI CORNER (ET-MC) that has already been installed. Ensure to pull it back with 12 mm gap for expansion if installed in cold weather. Fasten to the joists at a minimum of every 600 mm c/l. If you do not hit a joist you can add a piece of wood blocking at the end of the panel so the MULTI H Trim (ET-MH) has a fastening point. Keep with this procedure until the last panel needs to be cut leaving the 12 mm gap when it is slid into the MULTI CORNER (ET-MC). Now it is time to install the wall panels. You can install the wall panels exactly as per the section WALL ONLY Installation. The only difference is that the panel will be inserted into the track of the MULTI CORNER (ET-MC) instead of the J Trim at the top. Everything else is the same.

## 4.

**Method for Regular Installation.** Install the ceiling without any trim at the junction of the ceiling and wall. Ensure you leave the required clearances at each end for future expansion if installed in cold weather. After installation of the ceiling panels, install the J Trim based on the method of whether the J Trim goes all the way to the floor or not. Once all the wall panels are installed (as per WALL ONLY Installation) then you need to go back and install the CROWN BASE and CAP. Premeasure and miter cut for each corner with the base and cap installed together (Picture J). Install the CROWN BASE first and ensure the screw is fastened in the little track (Picture K). This will allow the flex piece to not have any bulges. Then slip in the CROWN CAP to cover up all the screws.



Picture J



Picture K

BOLEX Group s.r.o.

+421 905 755 895   info@bolex-systems.eu

**www.bolex-systems.eu**

# FEATURES & BENEFITS

- ✓ All Weather Interlocking System
- ✓ 100% Exterior Grade Virgin PVC
- ✓ Pre-Slotted Nailing Flange
- ✓ Hidden Fasteners Provide Smooth Finish
- ✓ Designed for Rigidity & Strength
- ✓ Resistant to Moisture & Most Chemicals
- ✓ Quick & Easy Installation
- ✓ Full Line of Trims
- ✓ Easy Maintenance – Simply Power Wash
- ✓ Resistance to Smoke and Flames

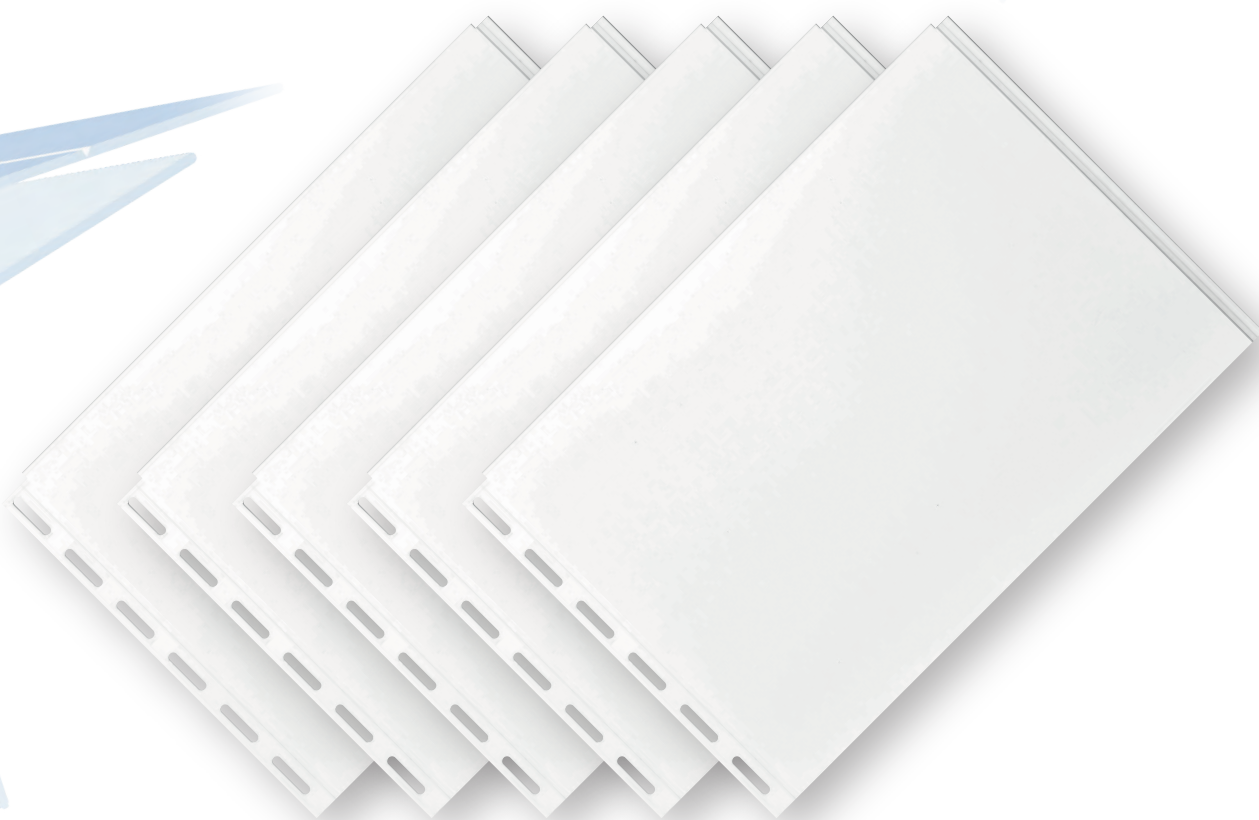

BOLEX Group s.r.o.

☎ +421 905 755 895    ✉ [info@bolex-systems.eu](mailto:info@bolex-systems.eu)

**[www.bolex-systems.eu](http://www.bolex-systems.eu)**